

4

3

2

1

D

D

C

C

B

B

A

A

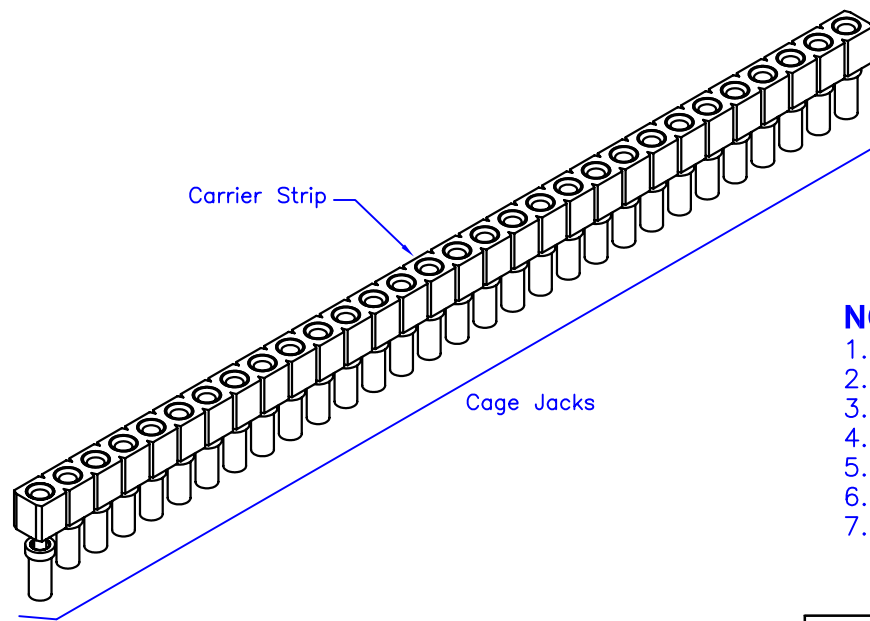
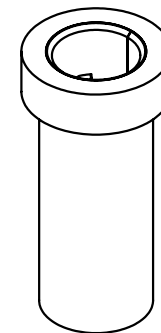
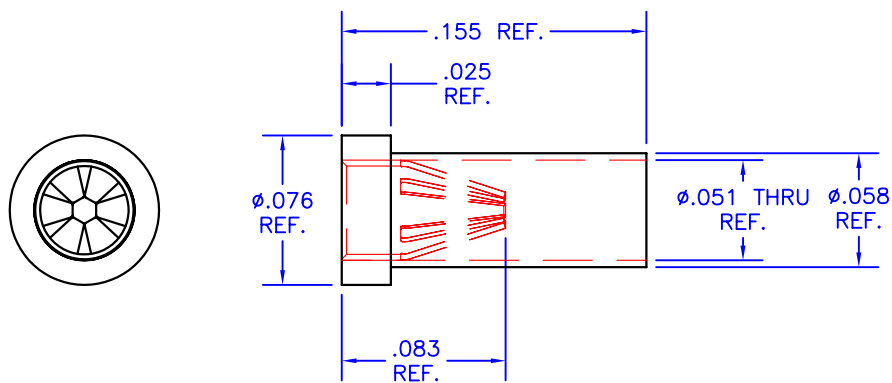
**NOTES:**

1. Unless otherwise noted, dimensions are in inches.
2. Shell: 360 brass, half-hard, with 200 μ m tin/lead over nickel
3. Contacts: Beryllium copper with 10 μ m gold over nickel
4. Current rating: 4.5 amps, for 10°C temperature rise.
5. Solder mount in minimum .059/.061 diameter mounting hole.
6. Mill-Max Part No. 0305-2-15-01-47-14-10-0
7. This receptacle is supplied on a 30-position carrier strip as Mill-Max part number S 703-93-130-47-050000.

TOLERANCES - UNLESS OTHERWISE SPECIFIED
 DIAMETERS: ± 0.002
 LENGTHS: ± 0.005
 ANGLES: $\pm 2^\circ$



TITLE		PIN RECEPTACLE FOR .025-.037 DIAMETER PINS			PART NO.		MS11	
SUBJECT		MECHANICAL DRAWING						
ENG:	TECH/DRAW:	DCA	SHL	OF	FILENAME:	REV	DATE	
D-M	D-M	46478	1	1	MS11-B	B	10/20/04	

4

3

2

1